

**Apartment With City  
Skyline View Naseby  
Grange Leeds LS9 7TE**  
**£59,950 Leasehold**

**haart**  
LEEDS

0113 440 0044

Available 8am - 10pm every day

[haart.co.uk](http://haart.co.uk)



Ref: HRT117100014



**13th Floor substantial one bedroom apartment with stunning Leeds Skyline views only a short walk from the city centre.**

- **One Large Double Bedroom**
- **Residents Parking Permit**
- **Stunning 13th Floor Views**
- **Modern Shower Room**
- **Fitted Kitchen**
- **Lift To All Floors**
- **City Centre**



## **Entrance Hall**

Entrance door leads into apartment from communal hall. Build in storage cupboards and doors to main rooms. Ceiling light

## **Lounge/Diner 16'10 x 9'10**

Double glazed windows with Leeds skyline views.

Radiator. Carpet. Central Ceiling Light

## **Kitchen 7'6 x 13'0**

Fitted with a range of wall and base units surmounted by a laminate work top with inset sink, space for fridge/freezer, washing machine, stand alone oven and hob. Wall mounted gas



central heating boiler. Double glazed window with impressive Leeds skyline views. Strip light. Cushion flooring.

### **Bedroom 10'1" x 13'0" (3.07m x 3.96m)**

Built in wardrobe with double doors. Double glazed window with impressive views. Ceiling light. Carpet.

### **Bathroom**

Fitted with a modern 3 piece white suite comprising double size open shower, wc and handbasin within built in vanity unit. Fully tiled walls and floor. Mirror above sink. Ceiling Ceiling Light



## GROUND FLOOR

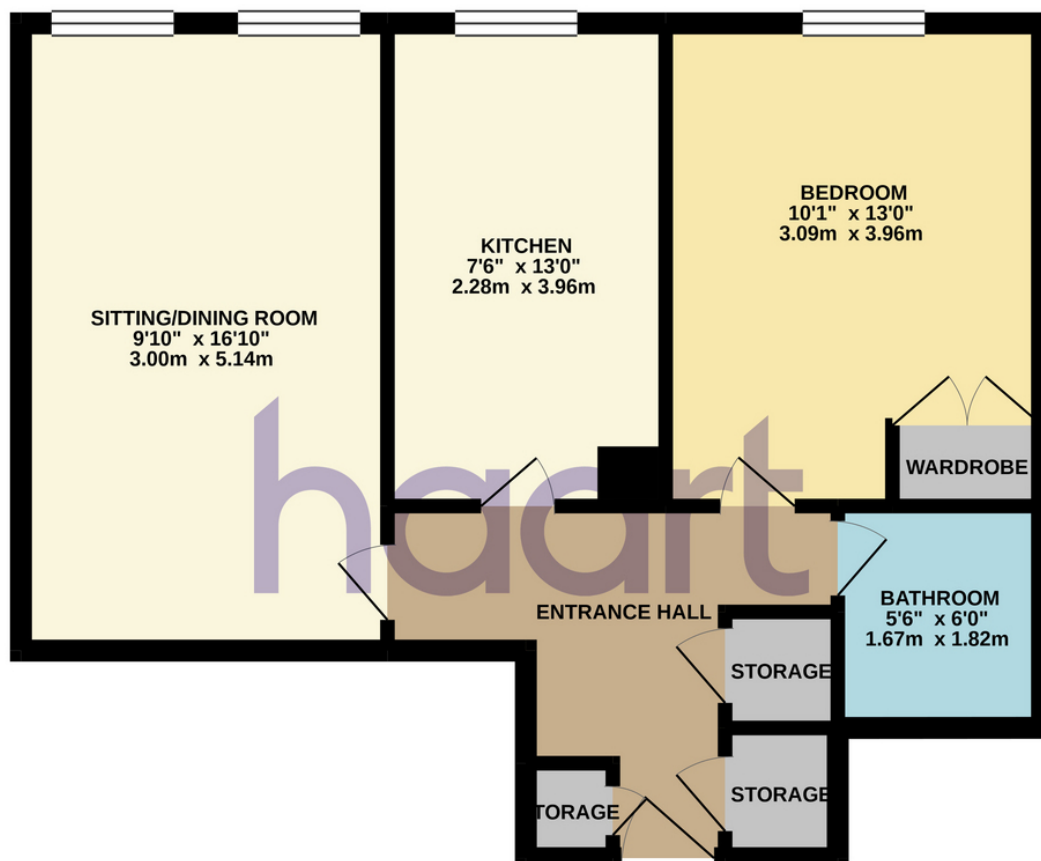

Whilst every attempt has been made to ensure the accuracy of the floorplan contained here, measurements of doors, windows, rooms and any other items are approximate and no responsibility is taken for any error, omission or mis-statement. This plan is for illustrative purposes only and should be used as such by any prospective purchaser. The services, systems and appliances shown have not been tested and no guarantee as to their operability or efficiency can be given.  
Made with Metropix ©2021

haart is a trading style of Spicerhaart Limited (Registered No. 3094936). Registered Office: Colwyn House, Sheepen Place, Colchester, Essex CO3 3LD.

haart is the seller's agent for the sale and marketing of the property described on these property particulars and your conveyancer is legally responsible for ensuring that the purchase agreement fully protects your position as a purchaser. haart makes detailed enquiries of the seller to ensure that the information provided is as accurate as possible. However, if you become aware that any of the information provided to you is inaccurate please inform your haart representative as soon as possible so we can make the necessary correction. The services at the property have not been tested.